

LAMPADA SEGNAPASSO DA INCASSO BIANCO MULTICOLOR IP65

IP65 MULTICOLOR WHITE RECESSED LED STEPLIGHT

tecno
switch
keep control

CONFORME ALLE NORME

IN CONFORMITY WITH NORMATIVES

LVD, EMC, EN61547, EN60598-2-2, EN61000-3-3,
EN61000-3-2, EN55015, EN60598-1, EN61058-1



modello
KEPLERO

230 Vac - 50/60 Hz

Potenza lampada 3 W

Sceita colore luce: Bianco Caldo/Neutro/Freddo con switch integrato

Ideale per cassette standard 503

Agganci per fissaggio in cartongesso inclusi

Corpo centrale in policarbonato

Contiene due placche in alluminio anodizzato (silver e bianca)

Schermo in PMMA satinato

Collegamento con fili uscenti dal retro

Ridotta emissione di calore

230 Vac - 50/60 Hz

Lamp power 3 W

Light color choice: Warm/Natural/Cold White with integrated switch

For 503 standard box

Hoods for plasterboard installation included

Central case in polycarbonate

Contains two anodized aluminum plates (silver and white)

Satin PMMA front glass

Rear wires for electrical connection

Reduced heat emission

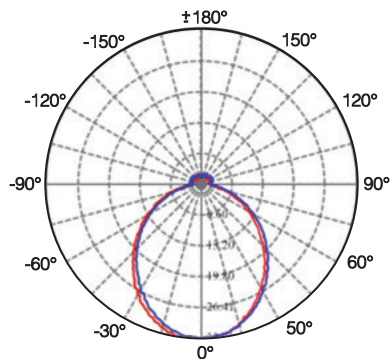

CODICE	POTENZA LED	COLORE LED	FLUSSO LUMINOSO	CRI	DURATA LED	LUNGHEZZA CAVI	PESO
CODE	LED POWER	LED COLOUR	LUMINOUS FLUX		LED LIFESPAN	CABLE LENGHT	WEIGHT
	W	K	lm		h	cm	gr
LA901BD	3	3000/4000/6400	250/280/250	>90	>40.000	15	100

CAMBIO COLORE LED

Si raccomanda di far eseguire le operazioni di installazione e manutenzione solo da personale qualificato.

1. Scollegare l'alimentazione elettrica;
2. Rimuovere il riflettore frontale facendo leva con un cacciavite fisso (Fig. 1-2-3);
3. Seguendo le indicazioni in "Fig.4", selezionare la tonalità di bianco desiderata agendo sullo switch frontale.

LED COLOR CHANGE

It is recommended to perform the installation and maintenance operations by qualified personnel only.

1. Disconnect the power supply;
2. Remove front glass by levering with flat screwdriver (Fig. 1-2-3);
3. Following the instructions in "Fig.4", set the desired shade of white using the front switch.

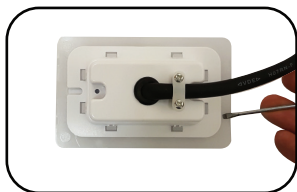

Fig.1

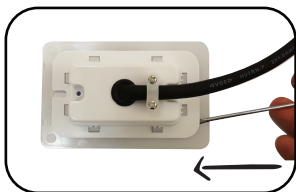

Fig.2

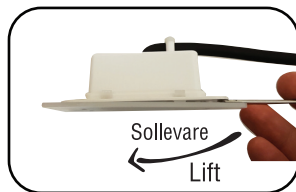

Fig.3

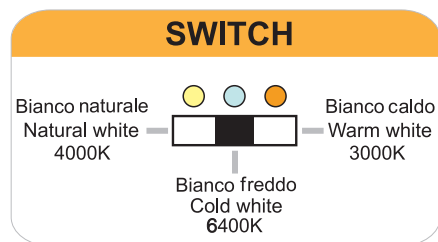

Fig.4

