



ELECTRONIC RECESSED THERMOSTAT - RAFFAELLO 230 - TE215VU ~

IN CONFORMITY WITH NORMATIVES

EN 60730-1, EN 60730-2-9



WARNINGS BEFORE INSTALLATION

- The device must be installed by qualified personnel.
- The device must be positioned about 1.5 meters above the floor, avoiding heat sources, windows and doors.
- The device must be installed in three modules recessed boxes type 503E.
- Two interchangeable faceplates are supplied, white and charcoal gray.
- The white front panel is pre-installed. If you want to change the color, follow the procedure described in the paragraph **"FRONT PANEL REPLACEMENT"**.
- Wiring diagram must be followed.

TECHNICAL SPECS

Power supply	230 Vac, 50-60 Hz
Relay type	1 changeover dry contact NO/NC
Max relay load	8(5)A - 250Vac
Temperature adjusting range	from +5 to +30°C
Sensor type	NTC - ±1%

INSTALLATION

1. Choose faceplates to use.
2. Choose among the 4 universal supports supplied the one compatible with the plate in possession (SEE SUPPORT INSTRUCTIONS) and install the thermostat following the order indicated in Fig.1

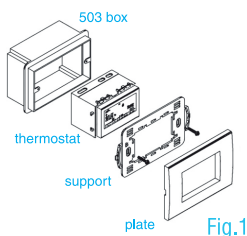

FRONT PANEL REPLACEMENT

The device comes with a factory-installed white faceplate. To replace it with a different color, proceed as follows:

1. Turn the knob on 5°C and make sure the switch is OFF.



2. Unhook the front panel, so also the knob, from the device by prying with a flat head screwdriver in the two side slots on the right side (Tecnoswitch logo side) and remove it from the device.

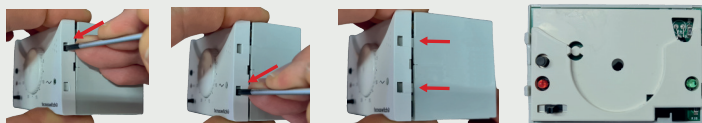

3. Align the right part of the front panel of different color to the side hooks, so press on the left side to fit it. Place the knob indicator at the value 5°C and press on the knob until it beats.



ELECTRICAL CONNECTIONS

Connect 230 Vac mains and the two wires of the heating / cooling system to the screw terminals on the back of the device following the diagrams in Fig. 2A e Fig. 2B

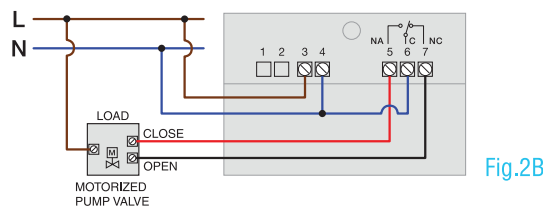
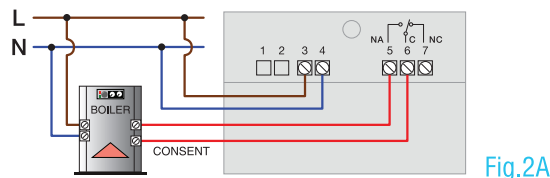

OPERATION

Thermostat can control heating and cooling systems:

- Placing the switch **SW** to the right ☀ the device works in heating mode.
- Placing the switch **SW** to the left ❄ the device works in cooling mode.
- To turn off thermostat, place the switch **SW** in the center OFF.

TEMPERATURE SETTING

Use the knob to adjust the desired temperature with a range from 5 to 30°C. When the heating/cooling system is running, the LED indicator L2 (load) flashes red every 5 seconds.

MAINS VOLTAGE CONTROL

Press the button T1 (test):

- if the led indicator (L1) ~ lights up, thermostat is powered.
- if the led indicator (L1) ~ is off, thermostat is not powered. Check the power supply.

