



## 230V ELECTRONIC RECESSED HUMIDISTAT - UM100VU ~

IN CONFORMITY WITH NORMATIVES

EN60730-1, EN60730-2-13



### WARNINGS BEFORE INSTALLATION.

- The device must be installed by qualified personnel.
- The device must be positioned about 1.5 meters above the floor, avoiding heat sources, windows and doors.
- Humidistat must be installed in three modules recessed boxes type 503E.
- Two interchangeable faceplates are supplied, white and charcoal grey. The white front panel is pre-installed. If you want to change the colour, follow the procedure described in the paragraph "FRONT PANEL REPLACEMENT".
- Wiring diagram must be followed.

### TECHNICAL SPECS

Power supply	230 Vac, 50-60 Hz
Relay type	1 changeover dry contact NO/NC
Max relay load	8(5)A - 250Vac
Relative humidity adjusting range	from 30 to 90%
Reading tolerance	RH ±3%
Humidity reading interval	every 10 seconds

### INSTALLATION

1. Choose faceplates to use.
2. Choose among the 4 universal supports supplied the one compatible with the plate in possession (SEE SUPPORT INSTRUCTIONS) and install the humidistat following the order indicated in Fig.1

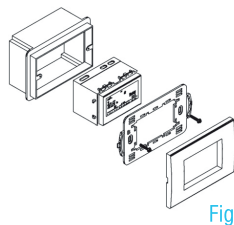

### FRONT PANEL REPLACEMENT

The device comes with a factory-installed white faceplate. To replace it with a different colour, proceed as follows:

1. Turn the knob on 30% and make sure the switch is ON.



2. Unhook the front panel, so also the knob, from the device by prying with a flat head screwdriver in the two side slots on the right side (TecnoSwitch logo side) and remove it from the device.

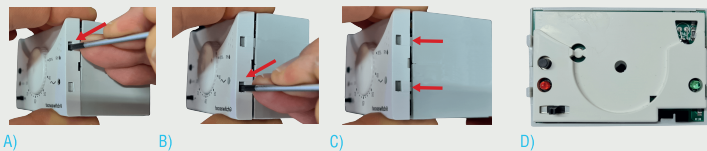

3. Align the right part of the front panel of different colour to the side hooks, so press on the left side to fit it. Place the knob indicator at the value 30% and press on the knob until it beats.



### ELECTRICAL CONNECTIONS

Connect 230 Vac mains and the wires of dehumidification (or humidification) system to the screw terminals on the back of the device following the diagrams in Fig. 2A e Fig. 2B

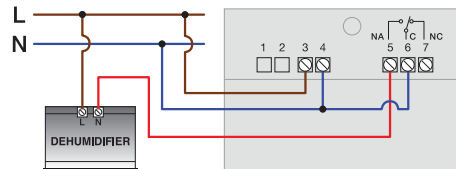

Fig.2A

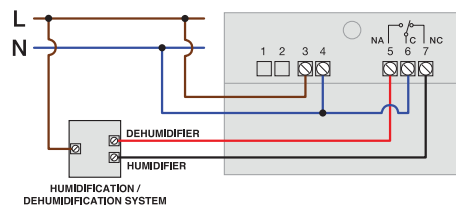

Fig.2B

### OPERATION

By setting the desired relative humidity threshold using the knob, the device will activate the dehumidification (or humidification) system when the ambient relative humidity exceeds the set threshold in order to keep the desired value constant.

The SW switch allows you to:

- Turn the device on by positioning it to the left ON.
- Turn off the device by positioning it to the right OFF.

**NOTE:** Placing the switch in the middle position (not printed) turns the device off.

### HUMIDITY THRESHOLD ADJUSTMENT

Use the knob to set the desired relative humidity threshold, with a range from 30 to 90%. When the relay contact is closed and thus the dehumidification/humidification system is in operation, LED indicator L2 (load) flashes red every 5 seconds.

### MAINS VOLTAGE CHECK

Press the button T1 (test):

- if the led indicator (L1) ~ light up, the device is powered.
- if the led indicator (L1) ~ is off, humidistat is not powered. Check the power supply.

