



ELECTRONIC RECESSED HUMIDISTAT - UM100BG

IN CONFORMITY WITH NORMATIVES
EN60730-2-13, EN55014, EN55032



WARNINGS BEFORE INSTALLATION

- The device must be installed by qualified personnel.
- The device must be positioned about 1.5 meters above the floor, avoiding heat sources, windows and doors.
- Humidistat must be installed in three modules recessed boxes type 503E.
- Two interchangeable faceplates are supplied, white and charcoal grey.
- The white front panel is pre-installed. If you want to change the colour, follow the procedure described in the paragraph "FRONT PANEL REPLACEMENT".
- Inserting the batteries incorrectly could damage the device.

TECHNICAL SPECS

Power supply	2 AA batteries (alkaline)
Relay type	1 changeover dry contact NO/NC
Max relay load	8(5)A - 250Vac
Relative humidity adjusting range	from 30 to 90%
Reading tolerance	RH ±3%
Humidity reading interval	every 10 seconds

INSTALLATION

1. Choose faceplates to use.
2. Remove the humidistat from its casing using the pull tab and remove the battery cover at the bottom of the appliance with a flat head screwdriver Fig.1.
3. Insert 2 batteries AA alkaline 1.5 V, respecting the polarity indicated on the bottom and reassemble the battery cover.
4. Choose among the 4 universal supports supplied the one compatible with the plate in possession (SEE SUPPORT INSTRUCTIONS) and install the humidistat following the order indicated in Fig.2.

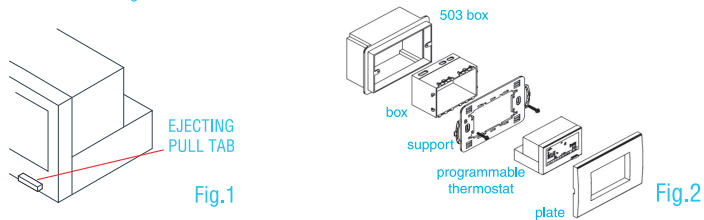

FRONT PANEL REPLACEMENT

The device comes with a factory-installed white faceplate. To replace it with a different colour, proceed as follows:

1. Turn the knob on 30% and make sure the switch is ON.



2. Unhook the front panel, so also the knob, from the device by prying with a flat head screwdriver in the two side slots on the right side (Tecno switch logo side) and remove it from the device.

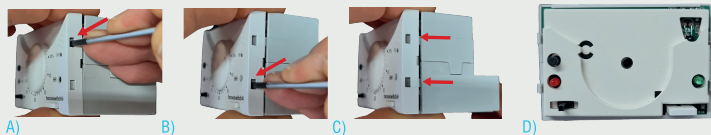

3. Remove the pull-out tab (down to the right) by pulling it out first, then turn it down to pull it out of its housing. Then assemble the extraction tab of different color, following the procedure inverse to that of disassembly.

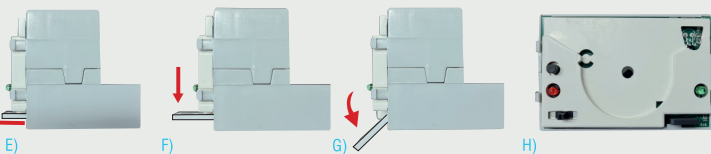

4. Align the right part of the front panel of different color to the side hooks and the pull-out tab and press on the left side to fit it. Place the knob indicator at the 30% value and press on the knob until it beats.



ELECTRICAL CONNECTIONS

After inserting the batteries, connect the wiring of dehumidification (or humidification) system to the screw terminals on the back of the device following the diagrams in Fig.3A or Fig.3B.

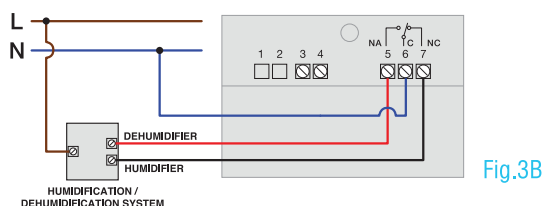
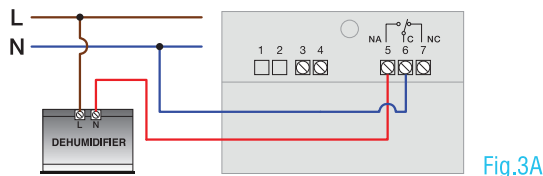

OPERATION

By setting the desired relative humidity threshold using the knob, the device will activate the dehumidification (or humidification) system when the ambient relative humidity exceeds the set threshold in order to keep the desired value constant.

The SW switch allows you to:

- Turn the device on by positioning it to the left ON.
- Turn off the device by positioning it to the right OFF.

NOTE: Placing the switch in the middle position (not printed) turns the device off.

HUMIDITY THRESHOLD ADJUSTMENT

Use the knob to set the desired relative humidity threshold, with a range from 30 to 90%. When the relay contact is closed and thus the dehumidification/humidification system is in operation, LED indicator L2 (load) flashes red every 5 seconds.

BATTERY CHARGE CHECK

Press the button T1 (test):

- if the led indicator (L1) light up, batteries are charged.
- if the led indicator (L1) is off, batteries are low. You have to replace it.

