



ELECTRONIC RECESSED THERMOSTAT - RAFFAELLO - TE215

CONFORME ALLE NORME

IN CONFORMITY WITH NORMATIVES

EN 60730-1, EN 60730-2-9, EN 60730-2-7

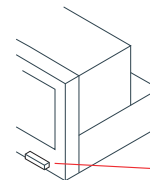
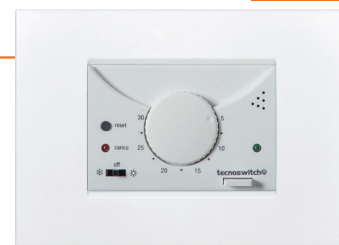

EJECTING PULL TAB

WARNINGS BEFORE INSTALLATION

- The device must be installed by qualified personnel.
- The device must be positioned about 1.5 meters above the floor, avoiding heat sources, windows and doors.
- The device must be installed in three modules recessed boxes type 503E.
- Two interchangeable faceplates are supplied, white and charcoal gray.
- The white front panel is pre-installed. If you want to change the color, follow the procedure described in the paragraph **"FRONT PANEL REPLACEMENT"**.
- Inserting the batteries incorrectly could damage the device.

INSTALLATION

1. Choose faceplates to use.
2. Remove the device from its casing using the ejecting pull tab and remove the battery cover at the bottom of the appliance with a flat head screwdriver.
3. Insert 2 batteries AA alkaline 1.5 V, respecting the polarity indicated on the bottom and reassemble the battery cover.
4. Choose among the 4 universal supports supplied the one compatible with the plate in possession (**SEE SUPPORT INSTRUCTIONS**) and install the thermostat following the order indicated in Fig.1

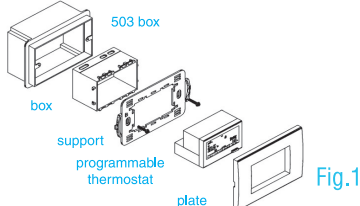

FRONT PANEL REPLACEMENT

The device comes with a factory-installed white faceplate. To replace it with a different color, proceed as follows:

1. Turn the knob on 5°C and make sure the switch is OFF.



2. Unhook the front panel, so also the knob, from the device by prying with a flat head screwdriver in the two side slots on the right side (ejecting pull tab side) and remove it from the device.

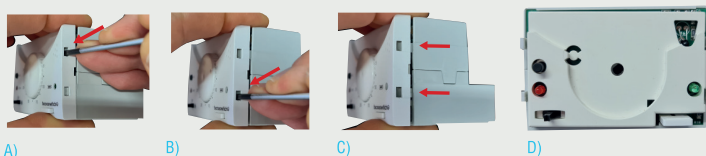

3. Remove the ejecting pull tab (down to the right) by pulling it out first, then turn it down to pull it out of its housing. Then assemble the extraction tab of different color, following the procedure inverse to that of disassembly.

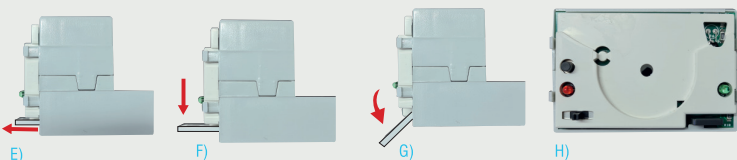

4. Align the right part of the front panel of different color to the side hooks and ejecting pull tab, so press on the left side to fit it. Place the knob indicator at the value 5°C and press on the knob until it beats.



ELECTRICAL CONNECTIONS

Connect the two wires of the heating / cooling system to the screw terminals on the back of the device following the diagrams in Fig. 2A e Fig. 2B

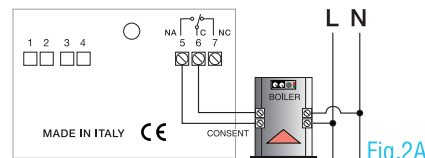

Fig.2A

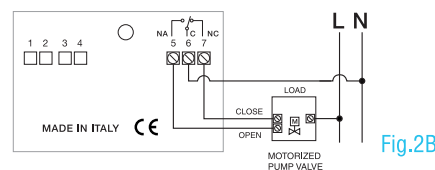

Fig.2B

OPERATION

The device can adjust heating and cooling systems:

- Placing the switch **SW** to the left , the device works in cooling mode
- Placing the switch **SW** to the right , the device works in heating mode
- To turn off your device, place the switch **SW** in the center **OFF**

TEMPERATURE SETTING

Use the knob to adjust the desired temperature with a range from 5 to 30°C. When the system is running, the **LED indicator L2 (load)** flashes red every 5 seconds.

BATTERY CHARGE CONTROL

Press the button **T1 (test)**:

- if the led indicator (**L1**) lights up, batteries are charged
- if the led indicator (**L1**) is off, batteries are low. You have to replace it

Fig.3

